

Annexure D

BUILDING SAFETY CERTIFICATE

No.

Dated: 10.07.2024

It is certified that the existing building HUM CONVENT SCHOOL (name of the building or premises) at Karamsar Colony, New Subhash Nagar, Basti Jodhpur Ludhiana (address) is having block(s)/Floor(s) as per details below:

Detail of Block(s) in school	Block (1)	Block (2)	Block (3)	Block (4)	Block (5)	Block (6)
No. of Floor(s) in the Block	Ground + 3	—	—	—	—	—

The building is owned/occupied by HUM CONVENT SCHOOL (name of the Institution) have complied with the Building safety requirements in accordance with National Building code Rules, and verified by the officers concerned of Er. Swarnjeet Singh (Name of Department/ Govt.) on 08.07.2024 (date of inspection) in the presence of Mr. Bhupinder Singh (HUM CONVENT SCHOOL) (name and addresses of the Manager/Secretary or his representative) and that the building/premises is fit for occupancy for running school with effect from 10.07.2024 for a period of One years in accordance with rule and subject to compliance of the specific conditions as appended.

- 1.
- 2.
- 3.
- 4.

Issued on 10.07.2024 at 11:20 AM by

\* Strike out whichever is not applicable. In case of block is more than six use separate sheet for detail.

Signature with Seal:

Name:

Designation:

Name & Address of Department/ Office:

Er. Swarnjeet Singh  
BE (CIVIL)  
Glada Approved Structure Engineer  
REG. NO. EO/GLADA/LDH/2023/95

# S.S. BAINS & ASSOCIATES

Chartered Engineer, Building Designer, Valuer

Office : B-XXX1-311/190/1N, St. No. 2,  
Indira Colony, Chandigarh Road, Near Axis Bank  
Near Samrala Chowk, Ludhiana.  
Mb. : 98141-32832, 88720-32832  
E-mail : ssbains2bba@yahoo.com

Panel Valuer For Leading Nationalized Banks,  
Private Banks & Financial Institutions  
INCOME TAX VALUER U/S 34 AB



## Er. SWARNJEET SINGH

BE (CIVIL) MIE, FIV  
CHARTERED ENGINEER  
Regd. With **PUDA, MCL**  
**STRUCTURE ENGINEER**  
(PUDA APPROVED)  
Fellow of Institution of Valuers  
Income Tax Valuer  
Regd. No.  
CCIT/Ldh/JB/Valuer/151/2013-14/185  
Regd. With Director of Factories

" To Whom it May Concern "

Dt. 10.07.2024

### STRUCTURE STABILITY CERTIFICATE

(FIT & SAFE) (SCHOOL BUILDING)

**Name of the Owner** :- **Harsh Education Society** (Regd.) Through President  
Sh. Dev Prasad Sharma S/o Sh. Jeet Ram Sharma  
(Adhaar No. 9768 0860 6613) (Mb :- 96460-88888 & 98555-26111)

**Name of the School** :- **H.V.M CONVENT SCHOOL**

**Location** :- Abadi Karamsar Colony, New Subhash Nagar, Basti Jodhewal,  
Wakia Vill. Taraf Saidan, Tehsil & Distt. Ludhiana.

**Area** :- Total Area = 8470.00 Sq. Yd. = 76230.00 Sft.  
Set Back Area = 315'-3" x 20'-0" = 6305.00 Sft.  
Net Area = 76230.00 - 6305.00 = 69925.00 Sft.  
**7769.44 Sq. Yd.**

SR. NO.	WASIKA NO./ RENT DEED NO.	DATE	AREA	TOTAL AREA
1.	1588	25.04.2012	8Biswe (Pukhta) OR 2Kanal + 0Marle	1210.00 Sq. Yd.
2.	3109	01.06.2009	2Bighe (Pukhta) OR 10Kanal	6050.00 Sq. Yd.
3.	8270	15.07.2016		300.00 Sq. Yd.
4.	Rent deed Stam No. Z 521834 Dt.			910.00 Sq. Yd.
			<b>TOTAL AREA</b>	<b>8470.00 Sq. Yd.</b>

**Covered Area** :- Ground Floor = 22851.68 Sft.  
First Floor = 22851.68 Sft.  
Second Floor = 22851.68 Sft.  
Third Floor = 14354.60 Sft. &  
Mumty & lift = 598.95 Sft.  
**Total Cov. Area = 83508.59 Sft.**

**Status at the time of visit** :- Ground, First, Second & Third Floor + Mumty & Lift

cont.....2  
Er. Swarnjeet Singh  
BE (CIVIL)  
Glada Approved Structure Engineer  
REG. NO. EO/GLADA/LDH/2023/95





**Name of the Owner :- Harsh Education Society (Regd.) Through President Sh. Dev Prasad Sharma**

**Address :- Abadi Karamsar Colony, New Subhash Nagar, Basti Jodhewal, Wakia Vill. Taraf Saidan, Tehsil & Distt. Ludhiana.**

#### **SELF DECLARATION**

**I Harsh Education Society (Regd.) Through President Sh. Dev Prasad Sharma S/o Sh. Jeet Ram Sharma is the Owner of the property shown in the above photograph comprises in Abadi Karamsar Colony, New Subhash Nagar, Basti Jodhewal, Ludhiana. Khasra No. 452/2- 452/1- 453/2- 455/3- 455/1, Khata No. 484/519, 479/514, 479/1/514/1, 486/528, 493/528, Jamabandi 2007-08, Hdbst No. 172, Wakia Vill. Taraf Saidan, Tehsil & Distt. Ludhiana. **Vide Sale deed No. 1588 Dt. 25.04.2012 & Khasra No. 452/1- 453/2- 452/2- 455/3- 455/1, Khata No. 470/505- 475/510- 477/512- 484/519, Jamabandi 2002-03, Hdbst No. 172, **Vide Sale deed No. 3109 Dt. 01.06.2009 & Khasra No. 452/1- 453/2- 452/2- 455/3- 455/1, Khata No. 479/514- 479/514/1- 484/519- 486/521- 493/528, Jamabandi 2007-08, Hdbst No. 172, **Vide Sale deed No. 8270 Dt. 15.07.2016 & Khasra No. 452/1-453/2-452/2-455/3 -455/1, Khewat No. 479-479/1-484-486min-493, Khatoni No. 514-514/1-521-521min-528, Page No. 510-514-519-530, Jamabandi 2007-08, Hdbst No. 172, Wakia Vill. Taraf Saidan, Tehsil & Distt. Ludhiana. **Vide Rent deed Stam No. Z 521834 Dt.....**********

Signature of the Owner  
(To be signed by the owner in the presence of branch manager)

**HVM Convent Sr. Sec. School**

**President**

**Er. Swarnjeet S.**  
**BE (CIVIL)**  
Glada Approved Structure Engineer  
REG. NO. EO/GLADA/LDH/2023/95



## S.S. BAINS & ASSOCIATES

Chartered Engineer, Building Designer, Valuer

Office : B-XXX1-311/190/1N, St. No. 2,  
Indira Colony, Chandigarh Road, Near Axis Bank  
Near Samrala Chowk, Ludhiana.  
Mb. : 98141-32832, 88720-32832  
E-mail : ssbains2bba@yahoo.com

Panel Valuer For Leading Nationalized Banks,  
Private Banks & Financial Institutions  
INCOME TAX VALUER U/S 34 AB



## Er. SWARNJEET SINGH

BE (CIVIL) MIE, FIV

CHARTERED ENGINEER

Regd. With PUDA, MCL

STRUCTURE ENGINEER

(PUDA APPROVED)

Fellow of Institution of Valuers

Income Tax Valuer

Regd. No.

CCIT/Ldh/JB/Valuer/151/2013-14/185

Regd. With Director of Factories

:: 2 ::

Slab	:- RCC Slab Roofing
Walls	:- 4½" & 9" thick wall
Plaster	:- Both Side on walls
Flooring	:- IPS/Tile Flooring
Wood Work	:- Wooden Door's & Window's
Electrical Work	:- Underground Conduit wiring
Plumbing & Sanitation work	:- Underground
Age of Building	:- Constructed in 2010-11
Estimated future Life	:- 30 Year, if maintained properly

During the visit to the site it has been observed that the structure of the building which is existing comprising Ground, First, Second, Third Floor + Mumty & Lift with RCC Slab Roofing laid at all levels the structure of the building has not showned any defelections sagging of beams & Slabs the column have also not shown any buckling and piercing in the foundation till today from the above abeservation the structure of the existing building is safe and sound in all respects.

  
Er. Swarnjeet Singh  
BE (CIVIL)  
Glada Approved Structure Engineer  
REG. NO. EO/GLADA/LDH/2023/95





Name of the Owner :- Harsh Education Society (Regd.) Through President Sh. Dev Prasad Sharma

Address :- Abadi Karamsar Colony, New Subhash Nagar, Basti Jodhewal, Wakia Vill. Taraf Saidan, Tehsil & Distt. Ludhiana.

#### SELF DECLARATION

I Harsh Education Society (Regd.) Through President Sh. Dev Prasad Sharma S/o Sh. Jeet Ram Sharma is the Owner of the property shown in the above photograph comprises in Abadi Karamsar Colony, New Subhash Nagar, Basti Jodhewal, Ludhiana. Khasra No. 452/2- 452/1- 453/2- 455/3- 455/1, Khata No. 484/519, 479/514, 479/1/514/1, 486/528, 493/528, Jamabandi 2007-08, Hdbst No. 172, Wakia Vill. Taraf Saidan, Tehsil & Distt. Ludhiana. **Vide Sale deed No. 1588 Dt. 25.04.2012 & Khasra No. 452/1- 453/2- 452/2- 455/3- 455/1, Khata No. 470/505- 475/510- 477/512- 484/519, Jamabandi 2002-03, Hdbst No. 172, Vide Sale deed No. 3109 Dt. 01.06.2009 & Khasra No. 452/1- 453/2- 452/2- 455/3- 455/1, Khata No. 479/514- 479/514/1- 484/519- 486/521- 493/528, Jamabandi 2007-08, Hdbst No. 172, Vide Sale deed No. 8270 Dt. 15.07.2016 & Khasra No. 452/1-453/2-452/2-455/3 -455/1, Khewat No. 479-479/1-484-486min-493, Khatoni No. 514-514/1-521-521min-528, Page No. 510-514-519-530, Jamabandi 2007-08, Hdbst No. 172, Wakia Vill. Taraf Saidan, Tehsil & Distt. Ludhiana. **Vide Rent deed Stam No. Z 521834 Dt.....****

HVM Convent Sr. Sec. School

Signature of the Owner

(To be signed by the owner in the presence of branch manager)

President

Er. Swarnjeet Singh  
BE (CIVIL)  
Glada Approved Structure Engineer



**SITE PLAN/ LOCATION PLAN OF PROPERTY SITUATED ABADI KARAMSAR COLONY, NEW SUBHASH NAGAR,  
BASTI JODHEWAL, WAKIA VILL. TARAF SAIDAN, TEHSIL & DISTT. LUDHIANA.**

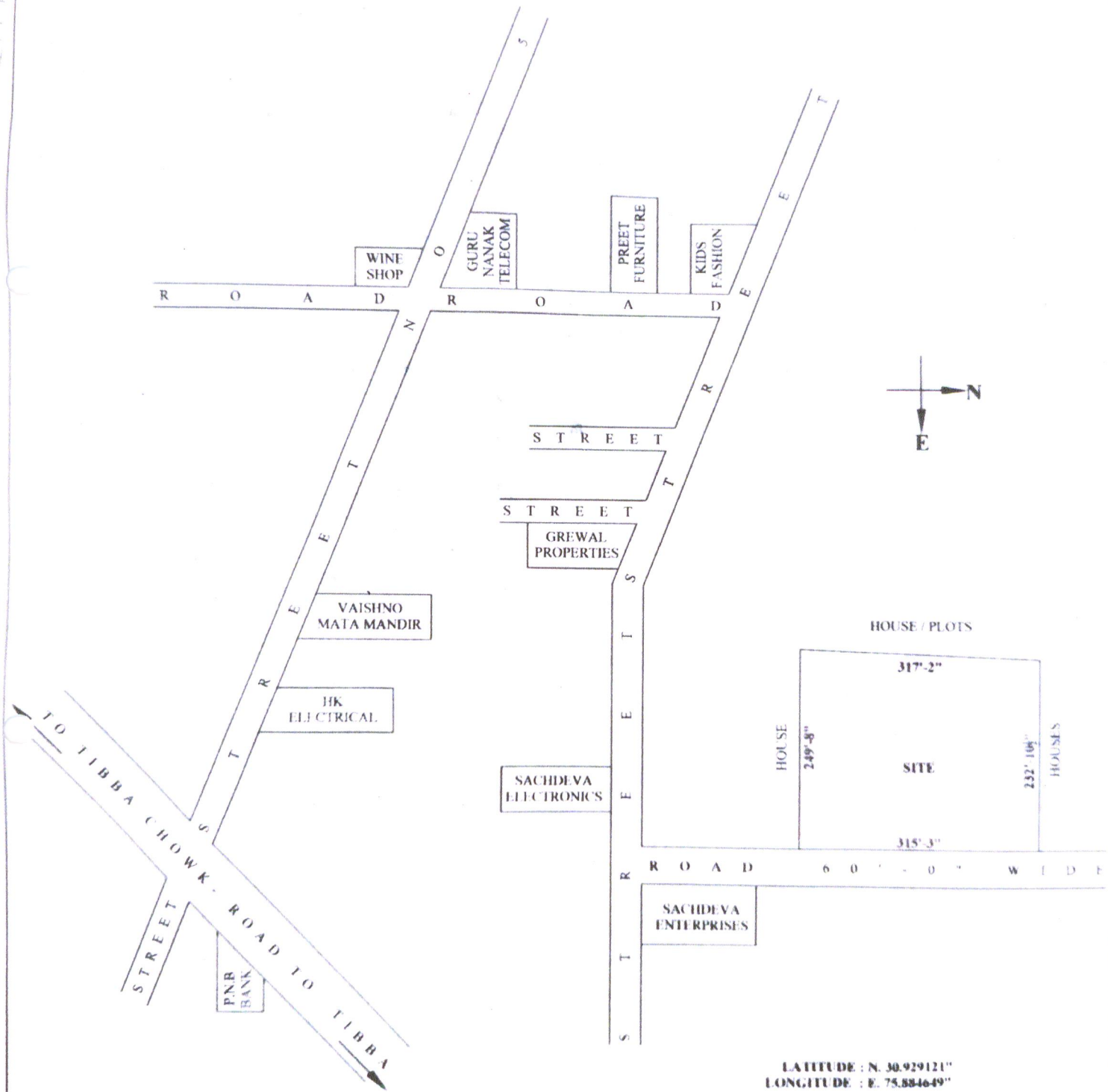

LATITUDE : N. 30.929121"  
LONGITUDE : E. 75.884649"

**Er. Swarnjeet Singh**  
BE (CIVIL)

Glada Approved Structural Engineer  
REG. NO. EO/GLADA/2024/1007  
DATE : 10.07.2024

SIGNATURE OF OWNER



NURSERY	TUITION FEES/ MONTH (Rs)
LKG	2300



HVM Convent Senior Secondary School



- Directions
- Call
- Directory

